

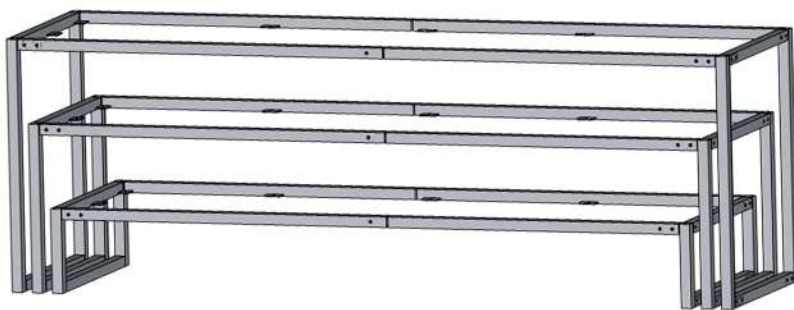

Designed & Made
in the
USA

THE BOX



Assembled Rail Length: TALL--86.5"
MEDIUM--81.5"
SHORT--76.5"

PARTS

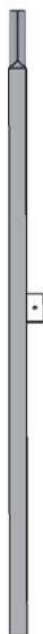

Rail A:
Insert End
(x2/rack)

TALL--45 1/4"
MEDIUM--42 3/4"
SHORT--40 1/4"



Rail B:
Receiver End
(x2/rack)

TALL--45 1/4"
MEDIUM--42 3/4"
SHORT--40 1/4"



Top Crossbar (x2/rack)



Bottom Crossbar (x2/rack)



Left
Corner Post
(x2/rack)



Right
Corner Post
(x2/rack)

OPTIONAL:
TIRE TOTTER



**LOCATE ALL PARTS
AND HARDWARE
BEFORE
BEGINNING RACK
ASSEMBLY**

*Recommended Plywood Dimensions
for Box Tops (Plywood Not Included):
Use 1/2" thick plywood for best results.*

Tall Box: 21.5" x 86.5"

Medium Box: 21.5" x 81.5"

Short Box: 21.5" x 76.5"

****If you plan to stain or paint
the plywood, complete this after
drilling the holes in Step 4.****

HARDWARE



5/16" x 3/4" Bolt



5/16"
Washer



1-1/4" Plug



5/16" x 1-1/2" Bolt



5/16"
Stopnut



Thread Rolling
Bolt

TOOLS NEEDED:

- * Socket Wrench with
1/2" Socket
- * 1/2" Wrench
- * Rubber Mallet
- * Drill and 3/8" Bit
- * Pencil or Chalk

OPTIONAL: C-Clamps

These assembly instructions apply to a single Box and are the same for all Box sizes.

STEP 1: Rail Assembly

NEEDED:

- Rails A (2) - Thread Rolling Bolts - Socket Wrench
- Rails B (2) - Rubber Mallet

A Slide each Rail A into a Rail B

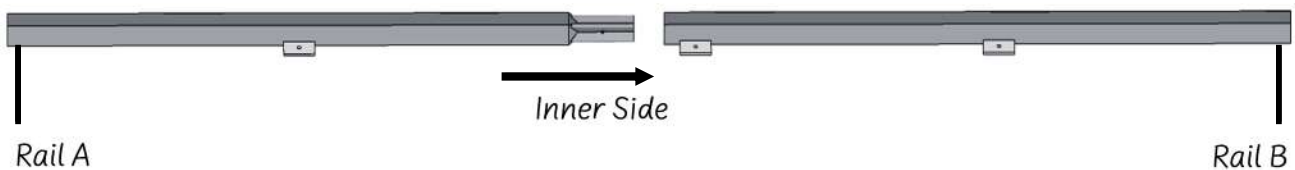

Align the single hole in Rail A with the single hole in Rail B (both on the same side). Double holes will be positioned at the ends of the rails.

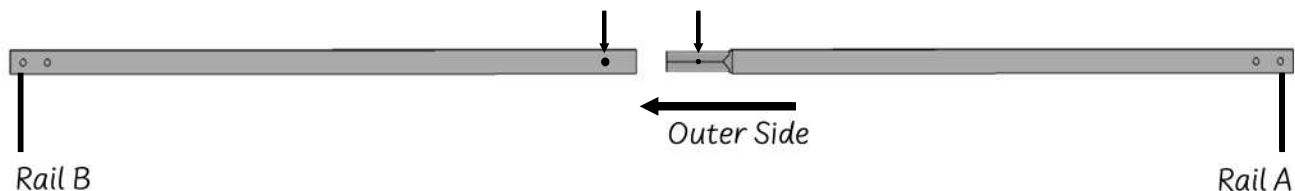

B Insert one Thread Rolling Bolt into each rail assembly. Apply steady downward pressure while turning, as the bolt will widen the hole. (Use a rubber mallet to align holes if needed.)

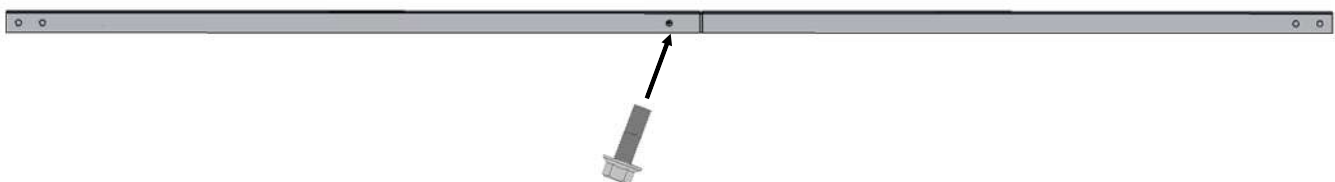

STEP 2: Corner Assemblies

NEEDED:

- Corner Posts - Top Crossbars - 5/16" Washers
- Bottom Crossbars - 5/16" x 3/4" Bolts - Socket Wrench

- A** Connect the two Left Corner Posts using one Top Crossbar and one Bottom Crossbar.

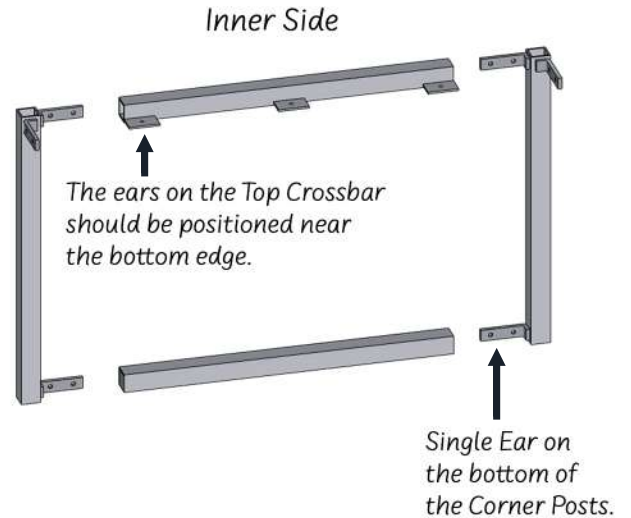
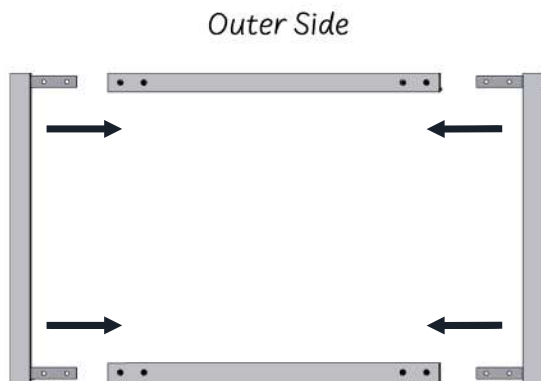

- B** Insert 5/16" x 3/4" Bolts with 5/16" Washers into the holes on the Outer Side of the Left Corner Assembly.

Insert each bolt just until it catches. Then, tighten each one a little at a time until all bolts are snug tightened (Fully Tighten in Step 4.)



- C** Repeat Steps 2A and 2B with the Right Corner Assembly.

STEP 3: Frame Assembly

NEEDED:

- Assembled Rails - 5/16" Washers
- Corner Assemblies - 5/16" x 3/4" Bolts

- A** Insert both rails into one of the Corner Assemblies, making sure the ears are facing inward.

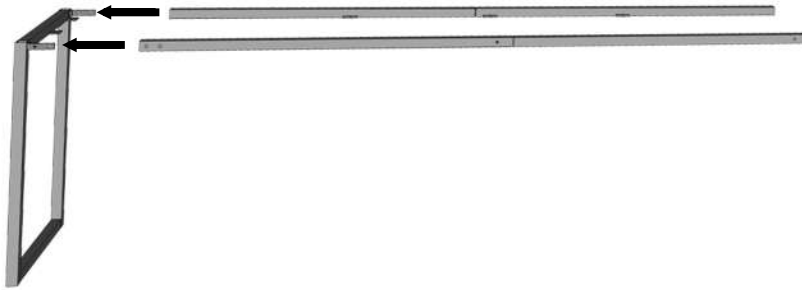

- B** Repeat with second Corner Assembly.



- C** At each outer corner of the Frame Assembly (where the Corner Assemblies meet the Rails), insert two 5/16" x 3/4" Bolts with 5/16" Washers. Insert each bolt just until it catches. Then, tighten all bolts gradually in a rotating pattern until they are snug tightened. (Fully tighten in Step 4.)

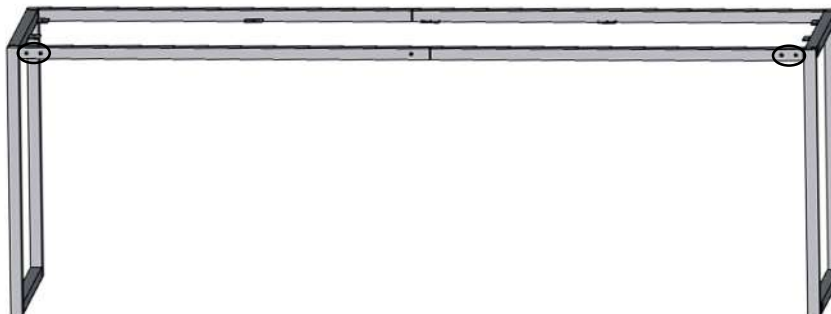

STEP 4: Top Installation

NEEDED:

- Plywood Sheet (Not Included)
- Drill & 3/8" Bit
- Pencil or Chalk
- 1-1/4" Plugs
- (Optional) C-Clamps
- 5/16" x 1-1/2" Bolts
- 5/16" Washers
- 5/16" Stopnuts

If staining or painting, do so after Step 4D

- A** Flip Box Frame onto its side. Insert 1-1/4" Plugs into the Tops and Bottoms of the Corners.

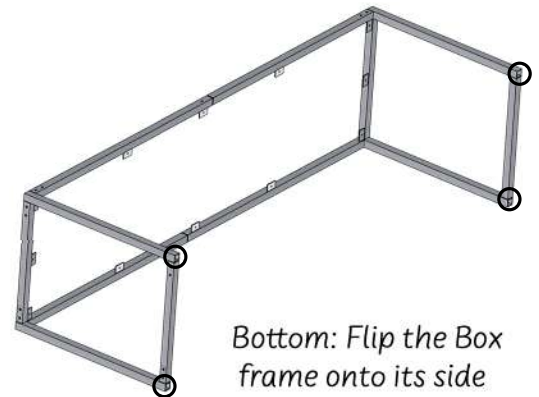
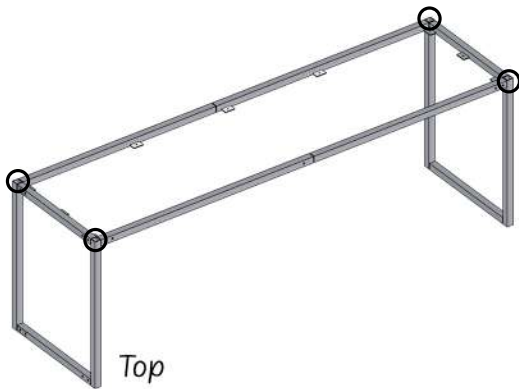

- B** Place the Plywood into the frame on what will be the top of the Box.

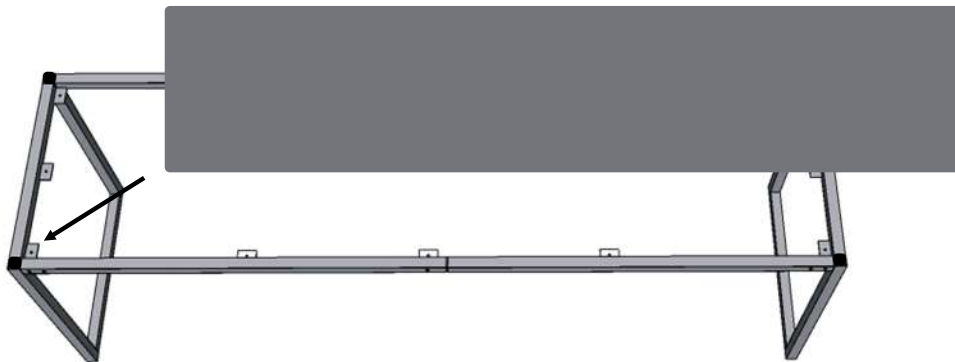

- C** With assistance, or secured with C-clamps as needed, mark the drill hole locations on the underside of the plywood using chalk or a pencil. *

*** If adding an optional Tire Totter to the Box top, assemble (pg. 7) and mark hole locations now.**

NOTE: Due to the nature of the materials, frame must be pushed down directly against the Plywood before marking for the most accurate hole placement

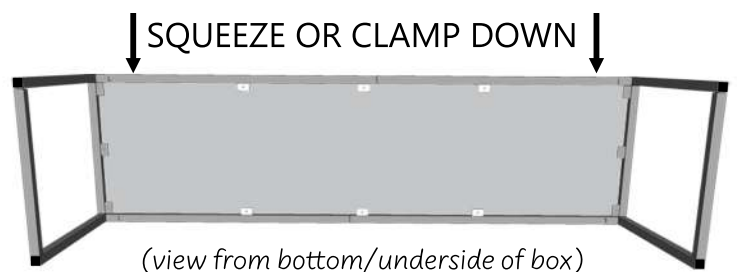

- D** Remove the Plywood from the frame and drill the marked holes.

NOTE: If staining or painting the plywood, do so AFTER the holes are drilled.

Hole Placement
Example for
Optional Tire Totter



- E** Stand the frame back up and place Plywood into the top of the frame. The marked side will serve as the underside of The Box top.

- F** Insert 5/16" x 1-1/2" Bolts with 5/16" Washers through the top surface holes. From underneath, attach a 5/16" Washer and 5/16" Stopnut to each bolt. Snug-tighten the bolts one at a time, gradually working around the surface. Do not over tighten.

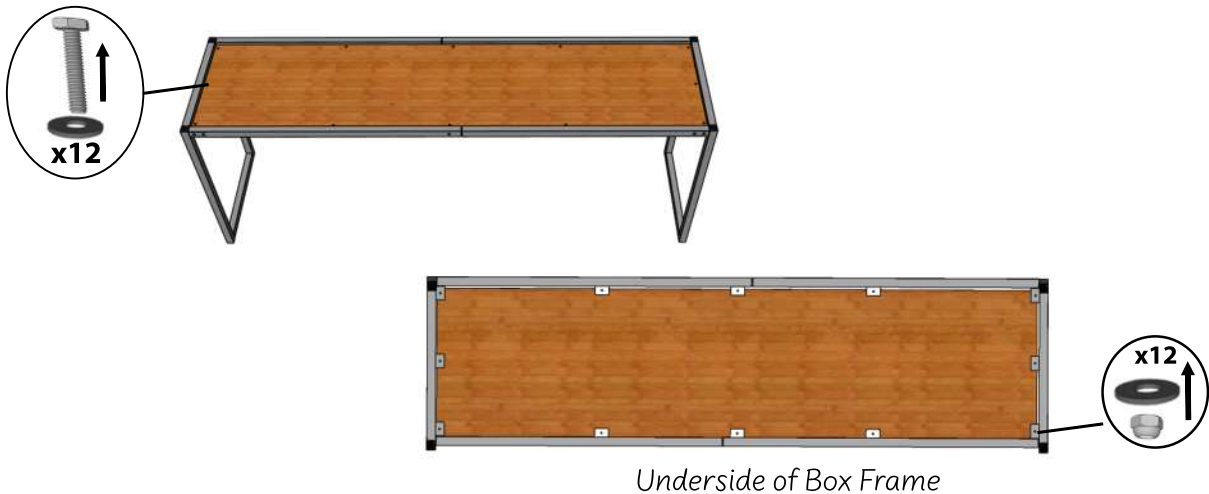

- G** Recheck all connections and snug tighten any loose bolts. Be careful not to over-tighten the Bolts, Washers, and Stopnuts securing the box surface.

The Box is now complete!

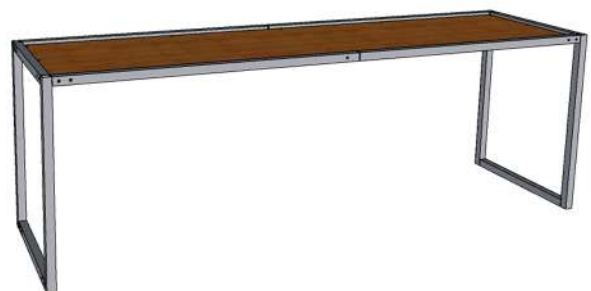

Tire Totter Assembly & Installation

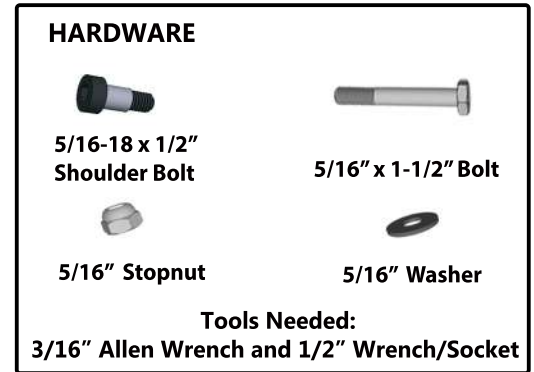
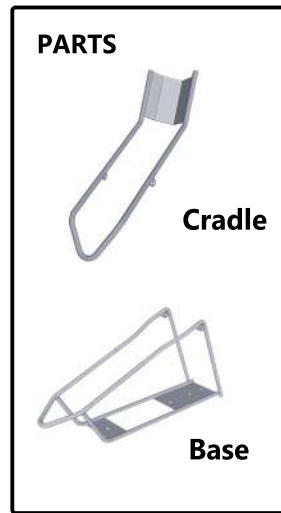

ASSEMBLY:

Position the cradle so its holes align with the base. Insert a Shoulder Bolt on each side, then fasten individually with one 5/16" Washer and one 5/16" Stopnut. Hand-tighten first, then fully secure with a 3/16" Allen Wrench once both are snug.



**YOUR TIRE TOTTER
IS NOW COMPLETE!**

INSTALLATION *(See Steps 4C and 4D for hole marking and drilling instructions.)*

Mount the Tire Totter to the Box by inserting four 5/16" x 1-1/2" Bolts with 5/16" Washers through the Tire Totter and Box surface holes. Secure from underneath with a 5/16" Washer and 5/16" Stopnut. Do not over tighten.

